

## Features

- Fixed 75cd strobe
- Available in surface-mount (standard) and Low Profile (LP) versions
- WPBB/LP made of clear Lexan® - provides maximum visibility and reliability, allowing full 75cd output
- Lens colors available in amber, blue, green, and red
- Super-Slide® Bracket – Ease of supervision testing
- Checkmate® - Instant voltage verification
- Synchronize strobe and/or horn with AVSM module
- Switch selection for high/low dBA
- Switch for chime, whoop, mechanical, and 2400Hz tone
- Input terminals accept 18 to 12 AWG
- Switch for continuous or temporal 3 tone (not available on whoop)
- Tamperproof re-entrant grill
- 5 year warranty



LP Version

Standard



7135-0328:0213  
7135-0328:0212

## Application

The CS/CHS-WP Series Outdoor Colored Lens Signals are wall mount, low profile strobes and horn/strobes that offer dependable audible and visual alarms for warning and emergency notification in outdoor locations. Applications include emergency communication, severe weather, emergency response and many more.

## Description

The CS/CHS-WP Series Outdoor Colored Lens Signals are 24VDC units available in lens colors of amber, blue, green and red. The Series has a fixed 75 candela strobe. They have a minimal operating current and a minimum flash rate of 1Hz regardless of input voltage. The weatherproof enclosure is made of clear Lexan® which provides maximum visibility and reliability for effective visible signaling, allowing full 75cd output. The strobes can be synced using a Gentex sync protocol or the AVSM Sync Module.

The Colored Lens Series is shipped with a die cast universal 4" mounting bracket which incorporates the popular Super-Slide® feature that allows the installer to easily pre-wire the system and test for supervision. The product also features a locking mechanism that secures the signal to the bracket without showing any screws. The Colored Lens Series also features the Checkmate® - Instant Voltage Verification Feature which allows the installer to check the voltage drop, current draw, and match against the blue print.

The CS/CHS-WP Series devices are available in two different versions. The standard version comes with a surface-mount back box (WPBB) to install directly on a wall. The Low Profile (LP) versions come with a low profile back box (WPLPBB) designed to be installed on a flush-mounted electrical box.

## Product Listings

- ANSI/UL 464 and 1638
- CSFM 7135-0328:0212 (CHS-WP Series)
- CSFM 7135-0328:0213 (CS-WP Series)

## Technical Specifications

Operating Voltage	Nominal 24VDC (16-33VDC)
Operating Temperature	-31°F - 150°F (-35° - 66°C)
Dimensions	LP Version - 5.75" H x 4.75" W x 3.25" D Standard - 5.75" H x 4.75" W x 4.18"D
Wiring Connections	Terminals accept 18 - 12 AWG
Mounting	LP Version – Single gang, double gang, or 4" square back box Standard Version - Surface mount back box included
Shipping Weight	2.05 lbs.

CS Series Outdoor Colored Lens Strobe, 75 Candela			
Model Number	Stock Number	Lens Color	Body Color
CS-24WAR-WP	4890140	Amber	Red
CS-24WAW-WP	4890141	Amber	Off-White
CS-24WBR-WP	4890142	Blue	Red
CS-24WBW-WP	4890143	Blue	Off-White
CS-24WGR-WP	4890144	Green	Red
CS-24GWG-WP	4890145	Green	Off-White
CS-24WRR-WP	4890146	Red	Red
CS-24WRW-WP	4890147	Red	Off-White
CSLP-24WAR-WP	4890148	Amber	Red
CSLP-24WAW-WP	4890149	Amber	Off-White
CSLP-24WBR-WP	4890150	Blue	Red
CSLP-24WBW-WP	4890151	Blue	Off-White
CSLP-24WGR-WP	4890152	Green	Red
CSLP-24GWG-WP	4890153	Green	Off-White
CSLP-24WRR-WP	4890155	Red	Red
CSLP-24WRW-WP	4890156	Red	Off-White

**NOTE:** Models with LP include the LP version enclosure.

UL Max Strobe Current Ratings (24VDC Regulated)		
Candela	Amber Lens	Blue, Green, and Red Lens
75cd	170mA	164mA

For unfiltered FWR ratings, see installation manual.

Horn Decibel and Current Ratings			
Horn Setting	Minimum dBA at 10', Per UL 464 (HIGH)	Minimum dBA at 10', Per UL 464 (LOW)	Regulated 24VDC Max. Operating Current, at High Setting (mA)
Temporal 3 2400Hz	78	71*	28
Temporal 3 Mechanical	76	70*	25
Temporal 3 Chime	70*	66*	15
Continuous 2400Hz	81	74*	28
Continuous Mechanical	80	72*	25
Continuous Chime	70*	66*	15
Whoop	82	69*	56

\*Operating the horn in this mode at this voltage will result in not meeting the minimum ANSI/UL 464 reverberant sound level required for public mode fire protection service. These settings are acceptable only for private mode fire alarm use. Use the high dBA setting for public mode application (not applicable when using the chime tone. The chime tone is always private mode).

CHS Series Colored Lens Strobe, 75 Candela					
Model Number	Stock Number	Lens Color	Body Color	Reverberant dBA at 10', per ANSI/UL 464	In Anechoic Room dBA at 10'
CHS-24AR-WP	4890160	Amber	Red	70-82	100
CHS-24AW-WP	4890161	Amber	Off-White	70-82	100
CHS-24BR-WP	4890162	Blue	Red	70-82	100
CHS-24BW-WP	4890163	Blue	Off-White	70-82	100
CHS-24GR-WP	4890164	Green	Red	70-82	100
CHS-24GW-WP	4890165	Green	Off-White	70-82	100
CHS-24RR-WP	4890166	Red	Red	70-82	100
CHS-24RW-WP	4890167	Red	Off-White	70-82	100
CHSLP-24AR-WP	4890168	Amber	Red	70-82	100
CHSLP-24AW-WP	4890169	Amber	Off-White	70-82	100
CHSLP-24BR-WP	4890170	Blue	Red	70-82	100
CHSLP-24BW-WP	4890171	Blue	Off-White	70-82	100
CHSLP-24GR-WP	4890172	Green	Red	70-82	100
CHSLP-24GW-WP	4890173	Green	Off-White	70-82	100
CHSLP-24RR-WP	4890174	Red	Red	70-82	100
CHSLP-24RW-WP	4890175	Red	Off-White	70-82	100

**NOTE:** Models with LP include the LP version enclosure.

**Tone Switch Locations**

Tone	Switch Position		
	3	4	5
Mechanical Temporal 3	ON	ON	ON
Mechanical - Continuous	OFF	ON	ON
2400Hz - Temporal 3	ON	OFF	ON
2400Hz - Continuous	OFF	OFF	ON
Chime - Temporal 3	ON	ON	OFF
Chime - Continuous	OFF	ON	OFF
Whoop	ON	OFF	OFF
Whoop	OFF	OFF	OFF

**NOTES:**

- Switch Positions 1 and 2 in the OFF position to select isolated horn and strobe power inputs
- Switch Position 6 ON = HIGH dBA
- Switch Position 6 OFF = LOW dBA

**Super Slide® Mounting Bracket**

Allows the installer to pre-wire the system, test for system supervision, remove the signal head until occupancy, switch out signals without changing mounting brackets and has locking edge connector for snap-in-place installation.

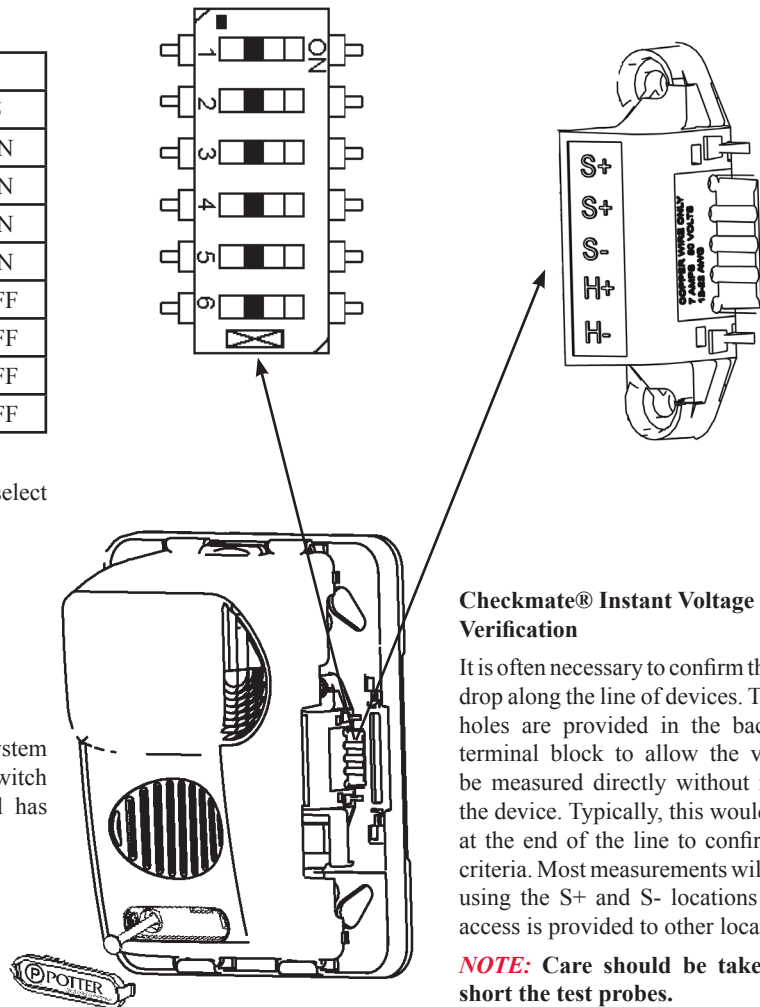

**Checkmate® Instant Voltage Verification**

It is often necessary to confirm the voltage drop along the line of devices. The access holes are provided in the back of the terminal block to allow the voltage to be measured directly without removing the device. Typically, this would be done at the end of the line to confirm design criteria. Most measurements will be taken using the S+ and S- locations although access is provided to other locations.

**NOTE:** Care should be taken to not short the test probes.

**Mounting Outdoor Enclosure**

Super Slide® Mounting Plate:

Mounts to WPBB Outdoor Enclosure

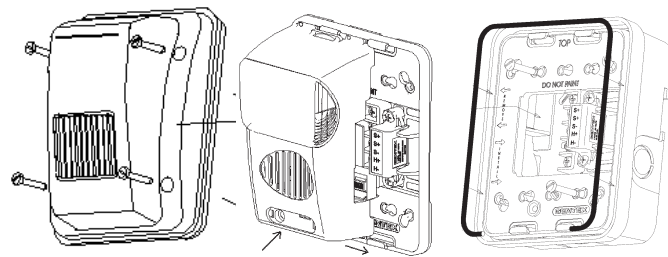

Super Slide® Mounting Plate:

Mounts to WLPBB Outdoor Enclosure

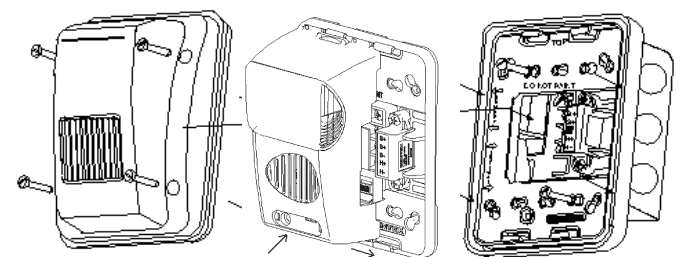

## Wiring Diagrams

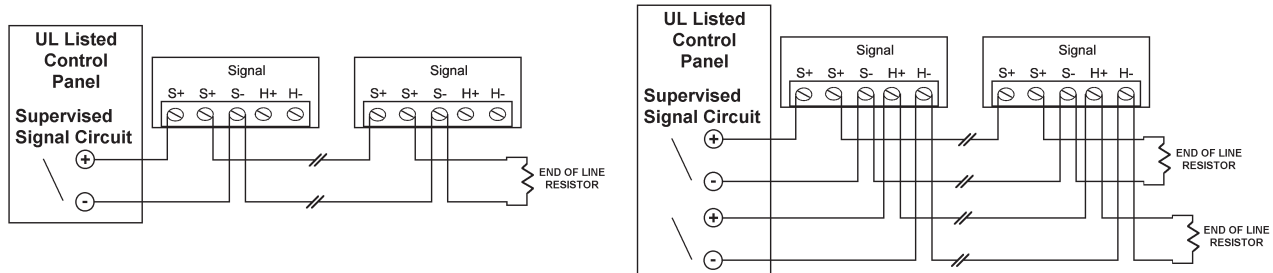

### NOTES:

- All strobes are designed to flash as specified with continuous applied voltage. Strobes should not be used on coded or pulsing signaling circuits. However, use of the AVSM control module or Gentex synchronization protocol is permitted to synchronize the strobe, horn and/or mute the horn.
- **FOR SYNCHRONIZATION WIRING INFORMATION, REFERENCE AVSM CONTROL MODULE DATA SHEET (8830050) AND/OR AVSM CONTROL MODULE MANUAL FOR SYNCHRONIZATION MODULE WIRING DIAGRAMS. AVSM CONTROL MODULE DATA SHEET AND MANUAL CAN BE OBTAINED AT <http://pottersignal.com> OR CALL POTTER ELECTRIC AT 1-800-325-3936.**

## Architect and Engineering Specifications

The audible and/or visible signal shall be Potter Outdoor Colored Lens Commander Series or approved equal and shall be listed by Underwriters Laboratories Inc. per ANSI/UL 1638 and/or ANSI/UL 464. The notification appliance shall also be listed with the California State Fire Marshal (CSFM). The notification appliance (combination audible/visible) shall produce a peak sound output of 100dBA or greater at as measured in an anechoic chamber. The signaling appliance shall also have the capability to silence the audible signal while leaving the visible signal energized with the use of a single pair of power wires. Additionally, the user shall be able to select either continuous or temporal tone output with the temporal signal having the ability to be synchronized.

The audible/visible and visible signaling appliance shall also maintain a minimum flash rate of 1Hz or up to 2 Hz regardless of power input voltage. The appliance shall have an operating current of 112mA or less for the 75Cd strobe circuit. The appliance shall also be capable of meeting the candela requirements of the ADA (75cd).

The appliance shall be polarized to allow for electrical supervision of the system wiring. The unit shall be provided with a mounting bracket with terminals with barriers for input/output wiring and be able to mount to a single gang or double gang box or double workbox without the use of an adapter plate. The unit shall have an input voltage range of 16-33 volts with either direct current or full wave rectified power for 24 volt models.

The appliance shall be capable of testing supervision without disconnecting wires. Also the appliance shall be capable of mounting to a surface back box. The unit shall also be able to verify voltage at the unit without removing unit.

The appliance has extended temperature range of -31° to 150°F (-35° to 66° C). The appliance shall satisfy virtually all outdoor and severe environment applications. The WPBB enclosure includes a gasket that must be inserted between the box and mounting bracket. There are drain holes in the back box to allow for drainage, the seal on the WPLPBB enclosure is not water tight. The WPLPBB enclosure includes a weather seal for mounting to wall and intended for use with universal electrical box. To allow for drainage, bottom edge of enclosure is not water tight.